

KRF tube terminals (NS) - No inspection hole

KRF630- 00NS

- ✓ Material: Cu 99.95%, tin plated Cu/Sn.
- ✓ No inspection holes.
- ✓ For stranded (class 2), multi-stranded (class 5) and very flexible (class 6) copper conductors according to IEC 60228.

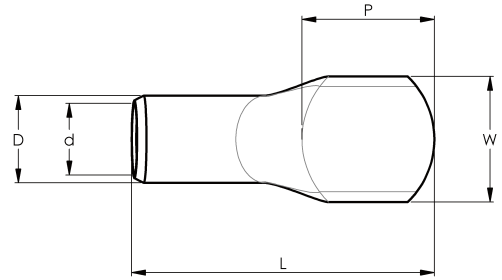

Item number: **7301-495900**

EAN: **7393487030459**

W (mm): **75**

P (mm): **80**

f (mm): **2**

d (mm): **39**

D (mm): **53**

L (mm): **195**

t (mm) - palm thickness: **13.8**

s (mm) - strip length: **80**

AWG/MCM Cu: **1250 MCM**

mm² Cu: **630**

