

Integrated dies for 1300C2 (13 t)

13CBC13

Die pair for Cu-branching with C-sleeves, oval crimping.

Through conductor 25-120 mm², branching 25-120 mm².

No die holders are needed. Used in the V1300C system.

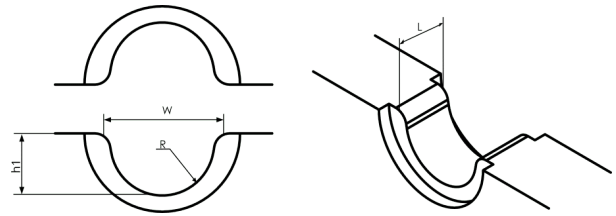

Item number: **5312-001300**

EAN: **7393487074682**

R, radius (mm): **11**

L (mm): **8**

h1 (mm): **12.8**

Crimp geometries: **Oval**

Number of crimps: **3**

mm² Cu: **95-190**

mm² C-sleeve Cu Range, Min: **95-190**

mm² C-sleeve Cu Range, Max: **95-190**

Through conductor, Min (mm²): **25-120**

Through conductor, Max (mm²): **25-120**

Branching, Min (mm²): **25-120**

Branching, Max (mm²): **25-120**