

Pre-insulated end terminals 0.14 - 95 mm<sup>2</sup> ETD,  
alternative colour

# A4-12ETD

- ✓ Material: Cu 99.95%, tin plated Cu/Sn, CSA approved.
- ✓ Polypropylene insulation, dimensions and colour code according to DIN46228.

Pre-insulated end terminal ETD, 4 mm<sup>2</sup>. Used with certified tool PEB0110T.

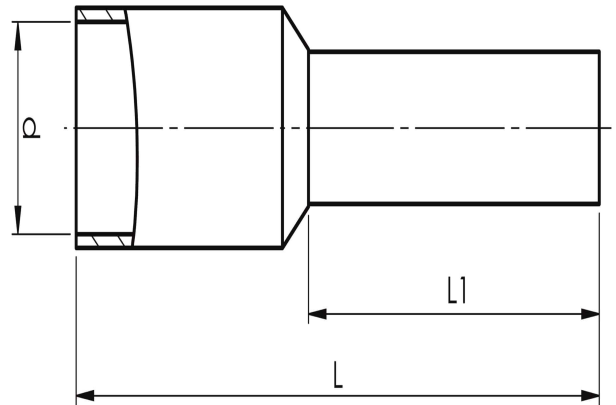

Item number: **7287-035700**

EAN: **7393487046344**

d (mm): **4.8**

L1 (mm): **12**

L (mm): **20**

s (mm) - strip length: **14**

Working temperature, Min (°C): **-5**

Working temperature, Max (°C): **105**

Insulation material: **PP**

Insulation colour: **Grey (end sleeves)**

Material: **Cu, Cu/Sn**

Measures acc DIN46228: **Yes**

AWG/MCM Cu: **12 AWG**

mm<sup>2</sup> Cu: **4**