

DIN 46235 tube terminals 6-400 mm²

KR300- 20DIN

- ✓ Material: Cu 99.95%, tin plated Cu/Sn.
- ✓ Dimensions according to DIN 46235, the number of crimps is indicated on the neck of the terminal.

Example of palm marking: 70 10

70 = mm² 10 = palm hole for M10

Tube terminal for multi-stranded (class 5) and stranded (class 2) Cu conductors (acc. to IEC 60228), 300 mm², with an M20 hole in the palm.

Used with Elpress certified systems V1300, V250.

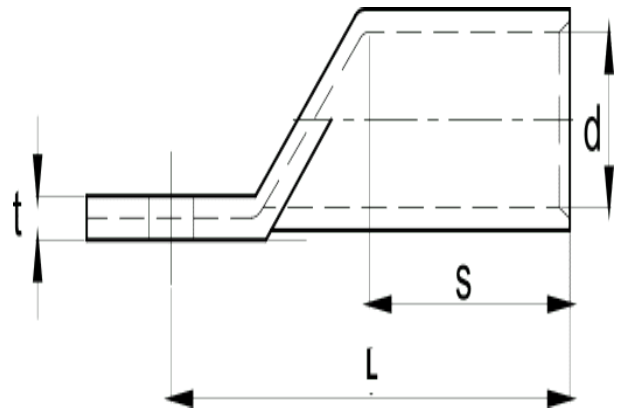
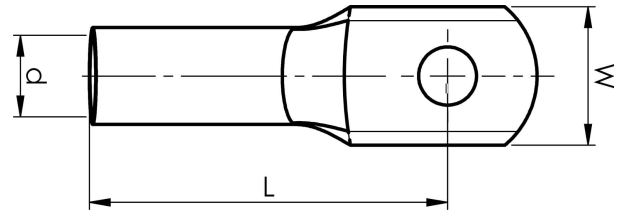

Item number: **7301-092100**

EAN: **7393487015159**

W (mm): **48**

N (mm): **20**

N1 (mm): **20**

P (mm): **40**

d (mm): **24.5**

D (mm): **32**

L (mm): **100**

s (mm) - strip length: **52**

Screw: **M20**

AWG/MCM Cu: **550 MCM**

mm² Cu: **300**