

DIN 46230 pin terminals 10 - 95 mm<sup>2</sup>

# B16SR

- ✓ Material: Cu 99.95%, tin plated Cu/Sn.
- ✓ Dimensions according to DIN 46230.

Uninsulated pin terminal for multi-stranded (class 5) and stranded (class 2) Cu conductors (acc. to IEC 60228), 16 mm<sup>2</sup>. Used with Elpress certified systems V600, V1300, V250.

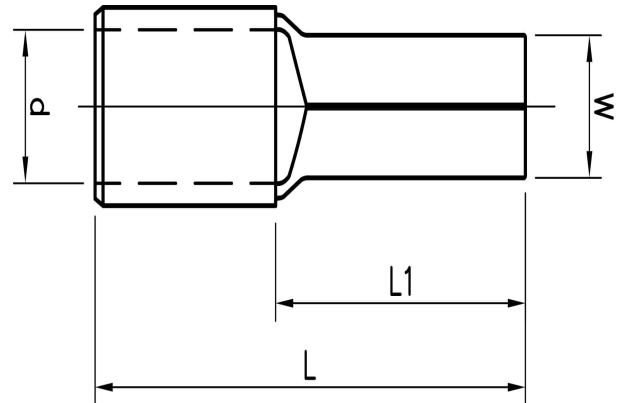
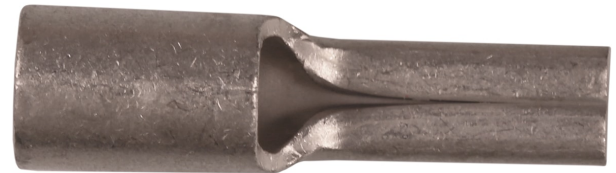

Item number: **7258-150200**

EAN: **7393487015173**

W (mm): **5.5**

d (mm): **5.8**

L1 (mm): **16**

L (mm): **26**

t (mm) - palm thickness: **1.2**

s (mm) - strip length: **1.2**

Material: **Cu, Cu/Sn**

AWG/MCM Cu: **6 AWG**

mm<sup>2</sup> Cu: **16**