

DIN 46230 pin terminals 10 - 95 mm<sup>2</sup>

# B35SR

✓ Material: Cu 99.95%, tin plated Cu/Sn.

Uninsulated pin terminal for multi-stranded (class 5) and stranded (class 2) Cu conductors (acc. to IEC 60228), 35 mm<sup>2</sup>. Used with Elpress certified systems V600, V1300, V250.

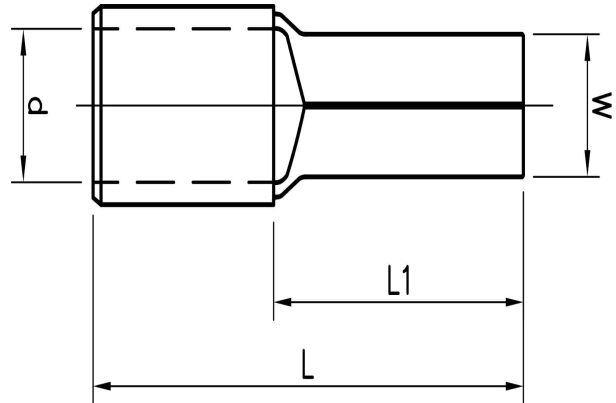
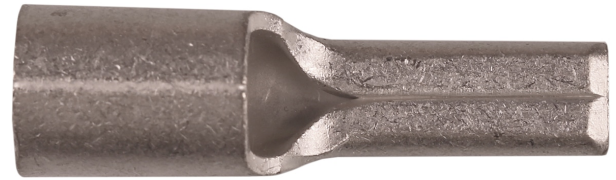

Item number: **7258-150400**

EAN: **7393487015197**

W (mm): **8**

d (mm): **8.4**

L1 (mm): **24.5**

L (mm): **40.5**

t (mm) - palm thickness: **1.5**

Material: **Cu, Cu/Sn**

AWG/MCM Cu: **2 AWG**

mm<sup>2</sup> Cu: **35**