

DIN 46230 pin terminals 10 - 95 mm²

B10SR

- ✓ Material: Cu 99.95%, tin plated Cu/Sn.
- ✓ Dimensions according to DIN 46230.

Uninsulated pin terminal for multi-stranded (class 5) and stranded (class 2) Cu conductors (acc. to IEC 60228), 10 mm². Used with Elpress certified systems V600, V1300, V250.

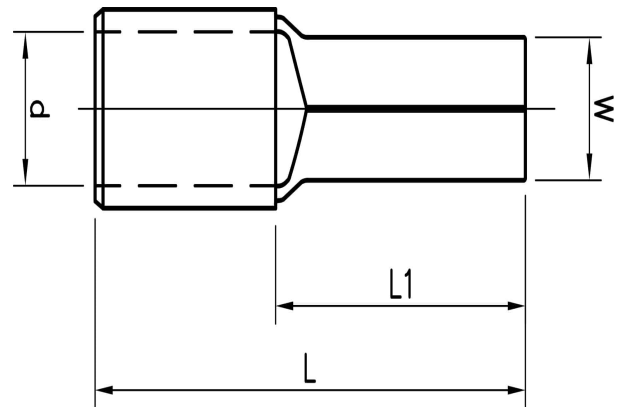

Item number: **7258-150100**

EAN: **7393487015166**

W (mm): **4.3**

d (mm): **4.5**

L1 (mm): **14**

L (mm): **22**

s (mm) - strip length: **1.1**

Material: **Cu, Cu/Sn**

AWG/MCM Cu: **8 AWG**

mm² Cu: **10**