

DIN 46230 pin terminals 10 - 95 mm²

B25SR

✓ Material: Cu 99.95%, tin plated Cu/Sn.

Uninsulated pin terminal for multi-stranded (class 5) and stranded (class 2) Cu conductors (acc. to IEC 60228), 25 mm². Used with Elpress certified systems V600, V1300, V250.

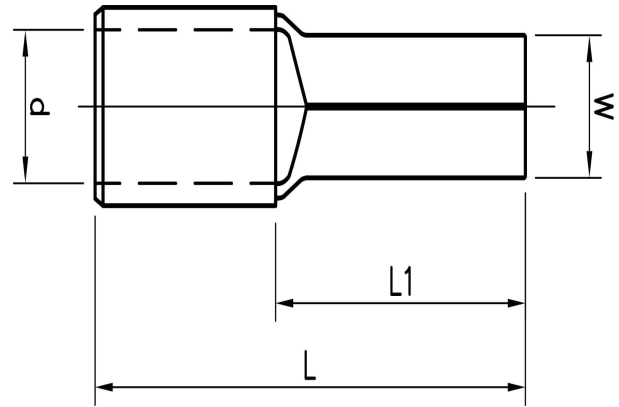

Item number: **7258-150300**

EAN: **7393487015180**

W (mm): **6.8**

d (mm): **7**

L1 (mm): **20**

L (mm): **33.5**

t (mm) - palm thickness: **1.2**

Material: **Cu, Cu/Sn**

AWG/MCM Cu: **4 AWG**

mm² Cu: **25**