

DIN 46230 pin terminals 10 - 95 mm²

B50SR

✓ Material: Cu 99.95%, tin plated Cu/Sn.

Uninsulated pin terminal for multi-stranded (class 5) and stranded (class 2) Cu conductors (acc. to IEC 60228), 50 mm². Used with Elpress certified systems V600, V1300, V250.

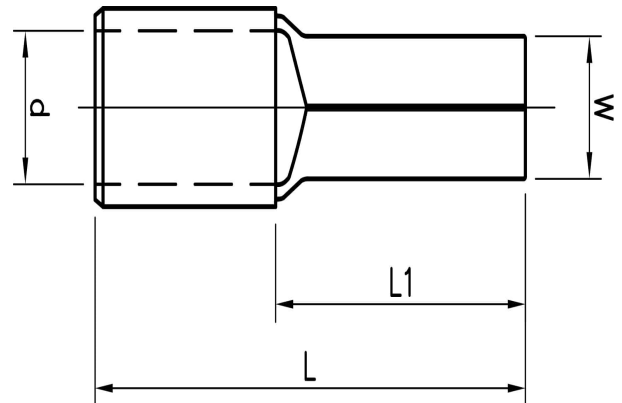

Item number: **7258-150500**
EAN: **7393487015203**

W (mm): **9.5**
d (mm): **9.6**
L1 (mm): **26**
L (mm): **45**
t (mm) - palm thickness: **1.8**

Material: **Cu, Cu/Sn**

AWG/MCM Cu: **1/0 AWG**
mm² Cu: **50**