

Aluminium through connectors with partition 16 -
1200 mm²

AS1200

- ✓ Used primarily for splicing two Al conductors with the same area.
- ✓ Two plus two crimps are needed.
- ✓ With partition.

Al through connector with partition for stranded, compressed Al cable 1200 mm². Used with Elpress certified system V1470.

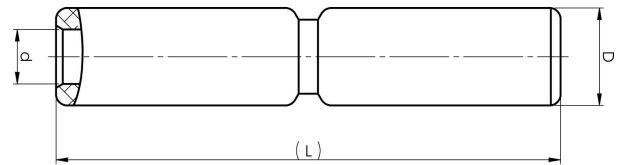

Item number: **7313-406700**

EAN: **7393487020092**

d (mm): **44**

D (mm): **70**

L (mm): **320**

s (mm) - strip length: **142**

AWG/MCM Stranded Al: **2500 MCM**

mm² Stranded Al: **1200**