

Integrated dies for 1300C2 (13 t)

# 13CBC15

Die pair for Cu-branching with C-sleeves, oval crimping.

Through conductor 120-95 mm<sup>2</sup>, branching 120-25 mm<sup>2</sup>.

No die holders are needed. Used in the V1300C system.

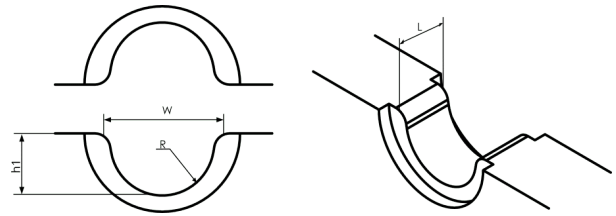

Item number: **5312-001500**

EAN: **7393487074699**

R, radius (mm): **13**

L (mm): **8**

h1 (mm): **14.5**

Crimp geometries: **Oval**

Number of crimps: **3**

mm<sup>2</sup> Cu: **175-240**

mm<sup>2</sup> C-sleeve Cu Range, Min: **175-240**

mm<sup>2</sup> C-sleeve Cu Range, Max: **175-240**

Through conductor, Min (mm<sup>2</sup>): **25-185**

Through conductor, Max (mm<sup>2</sup>): **25-185**

Branching, Min (mm<sup>2</sup>): **25-185**

Branching, Max (mm<sup>2</sup>): **25-185**